

FogHorn

Westport-South Beach Historical Society Newsletter
June 2020

A Beacon of Hope



Photo courtesy Capture, Share, Repeat and City of Westport

Que the narration: *"The world we live in is changing. However, some places will always remain the same. A place that calls to you to reset and connect with people and nature. In a time when there is so much uncertainty, there is one thing we know for sure. When the winds change and the time is right, we'll illuminate the lights to guide you back."*

In a stunning piece of social media engagement, Westport through its special marketing provider, Capture, Share, Repeat, with the help of the Society, the Lighthouse and "Light Keeper", produced

(Continued on Page 9)

**WESTPORT-SOUTH BEACH
HISTORICAL SOCIETY
2020
BOARD OF TRUSTEES**

President

Pete Eberle

Term Jan 2019 - Dec 2021

Vice President

Evelyn Robinson

Term Jan 2019 - Dec 2021

Secretary

Bobbi Willard

Term Jan 2020 - Dec 2022

Treasurer

Sherrie Williams

Term Jan 2018 - Dec 2020

Board Position I

Winnie Cragg

Term Jan 2020 - Dec 2022

Board Position II

Nicki Kollar

Term Jan 2018 - Dec 2020

Board Position III

Kimmi Kerns

Term Jan 2018 - Dec 2020

Executive Director

John Shaw

johnshaw98520@gmail.com

Education/Operations

Manager

Julie Smith

Julie.Smith.wsbhs@gmail.com

*The FogHorn is a publication
of the Westport-South Beach
Historical Society*

Editor: Kimmi Kerns

PO Box 1074
Westport, WA 98595
(360) 268-0078

www.wsbhs.org

on Face Book @
Westport-South-Beach-
Historical-Society

Message from your President - Pete Eberle



Dear Members of WSBHS,

Welcome to our new world of the Museum, Lighthouse, and Historical Society.

These are difficult times for all of us and we are facing many new challenges as we move towards reopening our venues for visitors. We have been closed to the public now for over three months and are getting ready for opening again. We want to make sure that we do this right to protect ourselves, our volunteers, employees and visitors. Grays Harbor County was able to move early into Phase 2 of opening activities back up to the public. It is unclear if we can open the lighthouse but the Museum is classed so that it will be one of the last things to open for the public. This has effected how we can view our other normal functions such as Quarterly Potlucks and also the Old Fashioned Fourth of July Celebration. Both of these have been canceled by the board. The majority of our Volunteers at these events and Docents are in the age groups that are most at risk to the COVID-19 virus and we are following state guidelines as best as we can.

Our new normal now consists of Zoom meetings instead of in person meetings. This has been a learning process for all of us and even a few moments of levity also. We are looking forward to this being all over and getting our organization back to normal. We are thankful to the support from the City of Westport and to our members who have donated to help pay our bills which keep on coming in. I also would like to thank John and Julie for showing the leadership they do along with our board members who continue to work to do what needs to be done. A big thank you goes out to Lowell and his crew out at the lighthouse on all the work they are doing to improve the look of the grounds and the lighthouse. Great job everyone.

Finally, once we are open again, I encourage everyone to stop by and see what we are doing to make our museum and lighthouse a fun and interesting place to visit.

You can now Donate to us on the Internet via PayPal!

Visit our website at **WWW.WSBHS.ORG**

Due to Governor Inslee's Covid-19 'Stay Safe, Stay Healthy' Restrictions most events have been cancelled. Please check our website and Facebook page periodically for event announcements.



**City Of Westport
Coast Guard City USA Designation Ceremony**

**The City of Westport
IS an
Officially Designated
Coast Guard City, USA**

The May dedication ceremony will be rescheduled. Watch our website, Facebook page and future Foghorns for the new ceremony date.

**Westport South Beach Historical Society
2020 SUMMER Calendar of Events**

June:

**Wild Float Release
LH and Museum re-opening
Rusty Scupper's Pirate Daze
GH Light Station 122nd - Lighting of the Light**

**On going at the beach
To Be Announced
COVID cancelled
Tuesday, June 30th at dusk**

July:

**Old Fashioned 4th of July
Booming Bay Fireworks Show, Westport**

**COVID cancelled
Saturday, July 4th at dusk**

August:

**National Coast Guard Day
GH Light Station Lighting (National LH day)
Tuna Classic
Westport Art Festival**

**Tuesday, August 4th
Friday, August 7th at dusk
COVID cancelled
COVID cancelled**

September:

74th Annual Seafood Festival & Craft Show

COVID cancelled

Executive Director's Corner

- by John Shaw

It is an interesting time for the Maritime Museum and Lighthouse. Being closed in compliance with the State's orders really puts a damper on our ability to stay on "Mission". It does not mean we are standing still. We have continued our engagement with the community, utilizing our locations as part of messaging during the COVID-19 crisis and with efforts to keep our traditions alive via virtual engagement.



Westport Mayor, Rob Bearden

The Society had an active role in the recent Blessing of the Fleet, keeping a sixty-year tradition going as was practical given social distancing and restrictions. I'd again want to thank all the partners in the effort, Myron Ness, City of Westport, Leslie Eichner and the Chamber of Commerce, WE fish, Barb Aue, our local Coast Guard Station and Grayson Bearden for pulling together a ceremony and sharing a virtual version to the community. Memorial Day was topped off with a playing of Taps from the top of the Lighthouse as part of this years "Taps Across America". We have reports that it was heard across town and also that, in the crowd in attendance, there was hardly a dry eye.



Laying of the Wreath

As we deal with COVID-19 issues and read about the pandemic in the early 20th Century I was struck that in all my recent reading of station logs and local history of that era, I find no mention of what was happening in the outside world. Seems we have always been relatively safe, or maybe Westport has always practiced social distancing in its own way. I am continually working through bits and pieces of our local history, so if any of our readers have a story to share related to the world pandemic please let us know.

One of the few benefits of having the doors closed is being able to work on projects. A big thank you to volunteers who have taken on projects in a socially distanced environment. Jeff and Marianne Pence and Pete Eberle have done great work seeing to both of our Fresnel lenses.

Lowell and the crew at the Lighthouse have been doing clearing and clean up on our property. Opening the viewscape for the Lighthouse along Ocean avenue will continue as part of our engagements there.

We have had a number of questions from community members as we have started work on the property near Surf Street. Readers may have heard about our proposed Surf Street Extension project in the past. Between our Lighthouse property and our neighbor to the West, State Parks, there is a 100' easement for the originally platted Surf Street. Note the attached drawing as a reminder of this project.

(Continued on Page 8)



A Day Spent Cleaning a Lighthouse Lens - by Pete Eberle

As the COVID-19 crisis continues and we start to move to more normal life, a couple hardy souls came to work, to ready our masterpiece lighthouse lenses for public viewing. On a Thursday in May, Jeff Pence, one of our former Board Presidents and Lighthouse keeper aficionado, and myself, Pete Eberle, met at the Grays Harbor Lighthouse to clean the lens. After meeting with John Shaw and Lowell Deaton to discuss our work plan, we headed up the stairs to the lens room carrying our supplies for the day. We each brought our favorite spray bottles filled with the Coast Guard Museum Curators recommended cleaning solution. The main thing that makes this cleaner special is that the intent is to not do any damage to the glass, framework or, most importantly, the litharge. Litharge is the putty that seals and holds the prisms in the frame sections and keeps air and moisture from reaching the tiny wooden wedges that hold the individual prisms in place. Litharge is a compound of calcium carbonate, lead, and linseed oil. Along with the cleaning gear, a two step ladder was hauled up to enable us to reach the top of the lens.



Once in the lens room we opened the lens access doors and removed the light shields from the lens. This enables us to easily reach all areas of the lens. Cleaning this lens is easy because most of the lens elements are easy to reach from inside or outside. Jeff started cleaning the inside of each prism while I worked on cleaning from outside the lens. This is how we practiced our social distancing while working in close quarters. Cleaning for us works like this. First we use a dust wand to remove the majority of the dust that has settled on the lens. Then we apply the cleaner with a micro fiber towel to clean the glass. Then a final wipe and polish with a linen towel or rag. Both of these are favored as they leave a minimum of fibers behind. Linen is getting increasingly harder to find. Three hours later we had finished with the cleaning and put the lens back together.

Since this cleaning went so well we agreed to meet at the museum on the following Saturday to clean the Destruction Island Lens. This was only possible if the City maintenance crew would loan us their 16-foot tall painters ladder. John would take care of this for us and let us know if all was a go. Confirmation came on Friday and we were on for Saturday.



The next morning we all showed up at the Museum and started our setup for Lens cleaning. We would use the 16-foot ladder for cleaning outside the lens and an 8-foot ladder to gain access to the inside of the lens. The Destruction Island Lens is a first order lens and is over 8 feet tall on the inside. Without a ladder one cannot reach the top of the lens from the lamp platform inside the rotating lens structure. We would only clean what we could safely reach inside and outside. Outside the lens with a 16 foot tall ladder it is impossible to reach the upper 2 feet of the prisms, as this

(Continued on Page 6)

Bear Sightings

Teddy bear hunts have been going on in neighborhoods all over the world as a fun distraction for children during the Covid-19 shutdowns. People place a teddy bear (or some other stuffed critter) in a front window or on a porch, easily visible from the street; and families driving or walking through the neighborhood see how many they can find, report and share.

Sightings are being reported from San Francisco to New Zealand. Some used the hashtag #GoingOnABearHunt to document their discoveries. In the South Beach, they're posting pics in a Facebook group called Westport Bear Hunt.

One of the most popular sightings became "Big Bear" in the Whale House. Organized by Julie Smith at the Maritime Museum, stuffed friends were seen in various windows of the Old Coast Guard Station and even taking a ride with our resident Gray Whale.



A Day Spent Cleaning a Lighthouse Lens

(Continued from page 5)

section slopes inward to the center of rotation. This means that we would not be able to clean the upper two feet of prisms. Jeff worked on cleaning the inside of the lens prisms and flash panels while I worked on the outside of the lens. To save from having to move the ladder around the lens, we disconnected the drive clutch, and were able to turn the lens by hand from the ladders. The large ladder was also kept from tipping into the lens by using security ropes tied to it and the viewing ramp railings. After just over 4 hours of work we completed cleaning the lens, but were both dissatisfied and promised to come back on our own to finish cleaning some details we were not satisfied with.

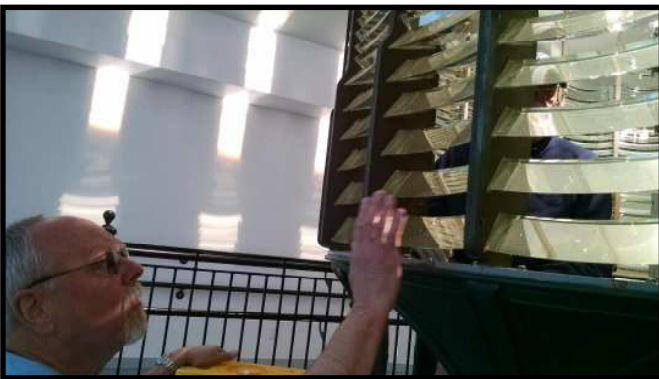

Besides making the lens look good, the cleaning allows us to assess the condition of the lens, from missing fasteners, to the condition of the glass and litharge. We also note and catalog any cracks, chips and other damage that the lenses have suffered over their lifetime, 125 years for the Grays Harbor lens and over 130 years for the Destruction island lens. One thing that we have seen that is different between the two lens is that the DI lens does not have any of the deposits on the prisms from chemicals leaching out of the glass over the years, that the Grays Harbor Lens

has. Also the DI lens has less color change in its glass. Both of these lens were made by the same manufacturer Henri LePaute & Sons of Paris France, which makes us wonder why they have aged differently over the years.

Having these lenses in our care is a great responsibility that we all take very seriously. We all enjoy showing these off to visitors and are proud of the work those before us put in to allow these to be in our care.

Kids Corner - Chief's Maze

- by Julie Smith

Help Chief
Find the
Museum

START



Answer Path on page 9

**PLEASE support our local businesses who
support US by their membership and/or donations
They need your support now more than ever !!**

Aloha Alabama
American Sunset RV & Tent
Basket House Gift Shop
Blackbeard's Brewery
Breaker's Boutique Inn
Brumfield Construction
Cachalot Kites & Toys
Capture, Share, Repeat
Chateau Westport
El Rancho Restaurant
Englund Marine Supply
First Interstate Bank
Glenacres Historic Inn

Gold Rush Charters
Grayland Hardware
Harbor Marine Supply
Havenwyld Ceramics
Holiday Motel
Hungry Whale
Lighthouse Bistro
Lost River Photography
Merino's Seafood
Merrill Photography
Pacific Motel & RV
Rogers Engineering
Seabird Gift & Candy Shop

Security State Bank
Shoalwater Bay Casino
Shop N Kart - Westport
Stitches
Twin Harbor Drug
Vacations by the Sea
Washington Coast Real Estate
WEfish
Westport Inn
Westport LH Writers Retreat
Westport, LLC
Westport Winery
Windermere - Westport

Executive Director's Corner

(Continued from page 4)

Proposed Surf Street Extension

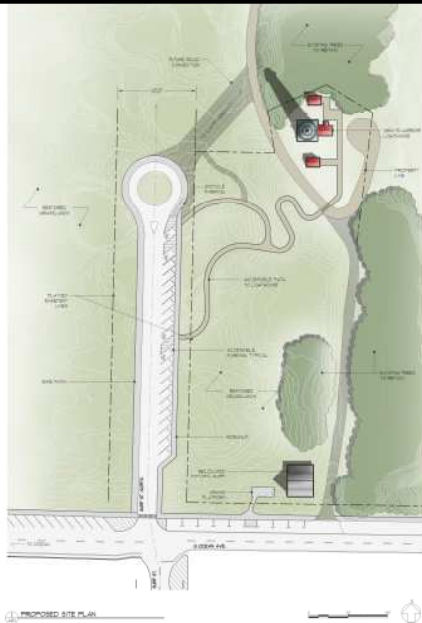

Our other current project is a new room at the Maritime Museum in remembrance of Dorothy Harrison and the Shell Flair Museum. Dorothy was a founding Member of the Society and its first President. Her Shell Flair Gift Shop and Museum on the corner of Ocean and Forrest was a tradition for Westport locals and visitors for fifty years. Through donations by the family, along with donations from several local citizens we have a nice story to tell as a reminder of what Shell Flair represented as Dorothy's passion for collecting and Westport.

We are just now stepping into the States Phase 2 of reopening protocols. Museums are specifically a Phase 3 eligible enterprise so it will be a few more weeks before we can advise the dates and details, but we look forward to opening the doors again. Stand by for more updates.



A Beacon of Hope

(Continued from front page)

a Covid-19 message that as of this writing has had 127,000 views and has been shared far and wide.



What started out as a messaging concept of using the Grays Harbor Lighthouse in its role as a beacon for Grays Harbor for the past 122 years, along with a bit of “we’ll keep the light on for you”, evolved into a true love letter to Westport and the South Beach.

Thank you to Greg Jacobs and Jill Adolf, Westport’s talented marketing and production folks, and to Jeff Pence, our ‘Light Keeper’, who is always there to make the Lighthouse shine.

(some pics of Greg and Jeff during video production)



If you by chance have not seen the video, you can find it online at www.experiencewestport.com or on Facebook at <https://www.facebook.com/ExperienceWestport/videos/822060611637184/>.

Kids Corner - Chief's Maze Solution

(Puzzle on page 7)

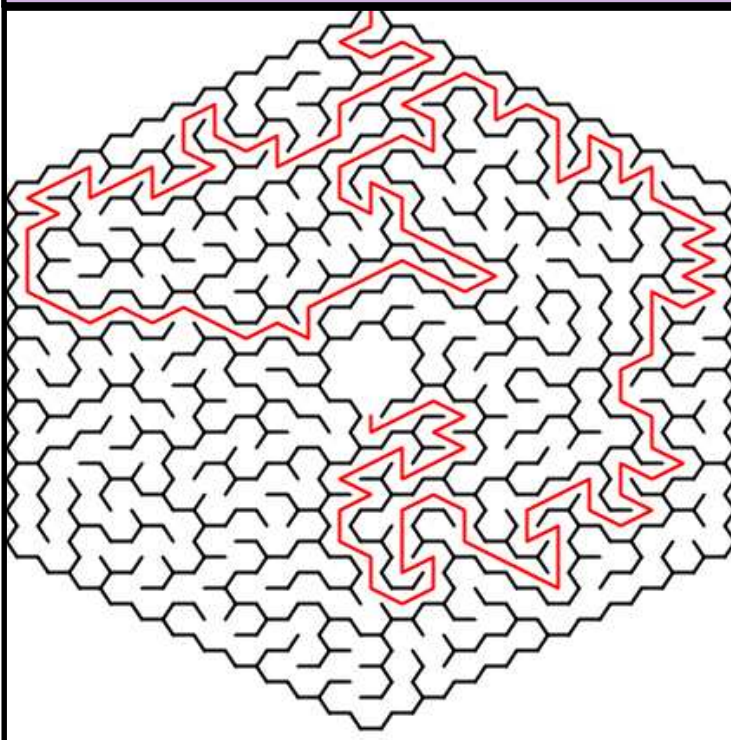

Glass Floats can STILL be Found !



Our Glass Float ‘Wranglers’ will be putting out glass floats for people to find on the beach through Labor Day.

If you find a float, please share via social media (#wildfloats2020 or #experiencewestport) or report it to the Museum and encourage others to do the same.

For those reporting their finds, there will be raffle drawings for larger ‘premium’ floats like the one above.

Remember to be safe out there and be aware of the wind and tides and practice social distancing.

Westport-South Beach Historical Society
Newsletter

PO Box 1074
2201 Westhaven Dr.
Westport, WA 98595

RETURN SERVICE REQUESTED

Put a stamp
here or it
won't get
mailed !!

Mailing Label Here

What is the Society's property and what is the Parks? Readers may have heard about our proposed Surf Street Extension project in the past. As we move towards that, we will be clearing down to the property corner that is marked with the original monument that was the point of beginning for the Coast Guard/Lighthouse Reservation. We will be creating an informational point there this summer.

